

LawnMaster®



21V LITHIUM **LINE TRIMMER**

SAFETY AND OPERATING MANUAL

PLEASE READ THIS MANUAL CAREFULLY BEFORE OPERATING THE UNIT

LB21LT



A STEELFORT PRODUCT



PROUDLY
NZ OWNED



TABLE OF CONTENTS

OPERATOR SAFETY	3
FEATURES & TECHNICAL DATA	5
ASSEMBLY	8
OPERATION	9
MAINTENANCE	11
STORAGE	11
WARRANTY	11

Thank you for purchasing our LawnMaster 21V Lithium Line trimmer, the information contained within this manual will help you to have many years of safe and trouble free use of this Lawnmaster product.

OPERATOR SAFETY

SAFETY RULES

This manual contains important safety information and instructions to operate the LawnMaster 21V Lithium Line Trimmer.

PLEASE READ THIS MANUAL CAREFULLY BEFORE USING THE UNIT.

Failure to adhere to the safety instructions could result in property damage and/or serious personal injury.

This manual should be considered a permanent part of the Line Trimmer and should remain with the unit at all times. All information in this publication is based on the latest product information available at the time of printing.

Product Information and specifications can be altered and/or improved without notice.

Content from this publication may not be reproduced without written consent.

DANGER

Indicates a hazardous situation which, if not strictly complied with, will result in substantial property damage and or serious injury.

WARNING

Indicates a hazardous situation which, if not strictly complied with, may result in property damage.

CAUTION

Indicates a hazardous situation which, if not strictly complied with, could result in property damage or personal injury. The warnings and precautions discussed in this manual does not cover all possible conditions and or scenarios that may occur. It must be understood by the operator that common sense and caution must be taken into consideration when operating this product, as these are factors.

GENERAL PRODUCT SAFETY

WARNING: Read all safety warnings, instructions, illustrations and specifications provided with this battery powered Line Trimmer. Save all warnings and instructions for future reference.

The term Battery Powered Line Trimmer refers to battery operated (cordless) product.

WORKPLACE SAFETY

- Keep work area clean and well lit. Cluttered or dark areas invite accidents.
- Do not operate the Line Trimmer in explosive atmospheres, such as in the presence of flammable liquids, gases or dust. The Line Trimmer can create sparks which may ignite the dust or fumes.
- Keep children and bystanders away while operating the Line Trimmer. Distractions can cause you to lose control.

ELECTRIC SAFETY

- The Line trimmer comes with a battery charger. Please ensure you use only the supplied charger to charge the battery in your Line Trimmer.
- Avoid body contact with earthed or grounded surfaces, such as pipes, radiators, ranges and refrigerators. There is an increased risk of electric shock if your body is earthed or grounded.
- Do not expose the Line Trimmer to rain or wet conditions. Water entering the Line Trimmer will increase the risk of electric shock.
- Never carry the charger by the cord and never unplug the power cord by pulling on it. Keep the cord away from heat, oil, sharp edges, and moving parts. Damaged or tangled cords increase the risk of electric shock.
- Always ensure the power supply to the battery charger is turned off before plugging the charger in or out of the mains power supply.

PERSONAL SAFETY

- Stay alert, pay attention to what you're doing, and use common sense when operating the Line Trimmer. Never use the Line Trimmer if you're tired or under the influence of drugs, alcohol, or medication. A moment of inattention can lead to serious personal injury.
- Always use personal protective equipment. Wear eye protection at all times. Depending on the conditions, use additional protective gear such as a dust mask, non-slip safety shoes, a hard hat, or hearing protection to reduce the risk of personal injury.

- To prevent unintentional starting, ensure that your hand is not near the on /off trigger before connecting the battery pack to the Line Trimmer.
- Ensure that all tools required to attach or remove the Trimmer nylon head from the Line Trimmer are removed before starting the machine. Leaving tools on or around the Line Trimmer after loosening or tightening the nylon head could result in personal injury.
- Do not overreach. Always maintain proper footing and balance to ensure better control of the Line Trimmer, especially in unexpected situations.
- Do not wear loose clothing or jewellery. Keep your hair and clothing away from moving parts. Loose clothes, jewellery or long hair can be caught in moving parts.
- Make sure all safety guards, handles and on/ off triggers are working correctly on the Line Trimmer, if any safety component has failed, please stop using and take it to your local LawnMaster dealer for repair.
- Do not let familiarity with Line Trimmers lead to complacency. Always follow safety principles, as a careless action can result in severe injury in just a fraction of a second.

LINE TRIMMER USE AND CARE

- Recharge only with the charger specified by the manufacturer. A charger that is suitable for one type of battery pack may create a risk of fire when used with another battery pack.
- Use the Line Trimmer only with the battery that was supplied with the Line Trimmer.
- When the battery pack is not in use, keep it away from metal objects such as paper clips, coins, keys, nails, screws, or any small metal items that could connect the terminals. Shorting the battery terminals together may cause burns or a fire.
- Under abusive conditions, liquid may be ejected from the battery; avoid contact. If contact occurs, rinse with water immediately. If the liquid comes into contact with your eyes, seek medical attention immediately. The liquid ejected from the battery may cause irritation or burns.
- Do not use a battery pack or battery charger that is damaged or modified. Damaged or modified batteries may exhibit unpredictable behaviour resulting in fire, explosion or risk of injury.
- Do not expose a battery pack or battery charger to fire or excessive temperature. Exposure to fire or temperature above 130 °C may cause explosion.
- Follow all charging instructions and do not charge the battery pack outside the temperature range specified in the instructions (10°C and 38°C).

Charging improperly or at temperatures outside the specified range may damage the battery and increase the risk of fire.

ADDITIONAL SAFETY WARNINGS

Some regions may have restrictions on using this product. Check with your local authorities for guidance.

- Do not use the product in bad weather, especially if there's a risk of lightning.
- Avoid operating the product on wet grass to ensure safety and optimal performance.
- Wearing hearing protection may limit your ability to hear warning sounds. Stay alert to potential hazards within and around the work area.

ADDITIONAL BATTERY SAFETY WARNINGS

- To prevent fire, injury, or damage, never immerse the product, battery pack, or charger in fluid, and keep fluids, especially corrosive or conductive ones, away from them.
- Charge the battery pack in temperatures between 10°C and 38°C.
- Store and use the battery pack in temperatures between 0°C and 40°C.

OVERLOAD PROTECTION

- LawnMaster 21V Lithium-ion batteries are designed with features that protect the lithium-ion cells and maximise battery life. If the product stops during use, the following may be the causes:
- The maximum current draw of the battery pack has been exceeded, causing it to automatically stop powering the product. Release the trigger to reset the product, and pull the trigger to resume operation.
- Excessive temperatures cause the battery pack to stop powering the product. If the battery pack is too warm, allow it to cool down.

SYMBOLS ON THE PRODUCT



Safety Alert



Read and understand all instructions before operating the product. Follow all warnings and safety instructions.



Wear eye, ear, and head protection.



Wear non-slip safety footwear when using the product.



Wear non-slip, heavy-duty gloves.



Beware of thrown or flying objects/
Keep all bystanders, especially
children and pets, at least 15 m away
from the operating area.



Keep hands and feet away from
the blade and cutting area.



Direction of blade rotation



Do not expose the product to rain or
damp conditions.



Remove the battery pack before
starting any work on the product.



Regulatory Compliance Mark (RCM).
The product meets applicable
regulatory requirements.

FEATURES & TECHNICAL DATA

MODEL	
Battery	21V 2Ah Lithium
Run Time	15-25 Minutes
Charge Time	2.5 Hours
Telescopic Shaft Length	1100-1500mm
Nylon Line Diameter (Maximum)	2mm
No Load Speed	7000
Nylon Line Length	115mm from eyelet to cutter
Weight	4.2kg

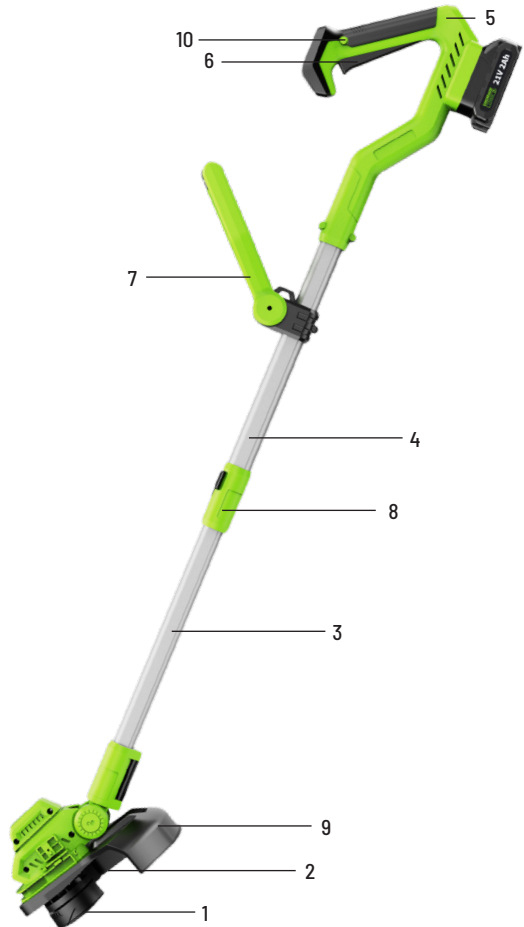

1.	Nylon Head
2.	Line Cutter
3.	Lower Shaft
4.	Upper Shaft
5.	Rear Handle
6.	Activation Trigger
7.	Front Handle
8.	Telescopic Shaft Lock
9.	Safety Guard
10.	Lock-Out Trigger

GETTING STARTED

1. Always wear safety goggles or safety glasses with side shields while operating the product. Use non-slip, heavy-duty protective gloves and non-skid, protective footwear to safeguard your feet and maintain stability on slippery surfaces.
2. The Line Trimmer features a telescopic shaft for easy adjustment. To adjust the shaft, open the locking level (point 1) and slide the lower shaft (point 2) in or out to your desired length. Once adjusted, close the locking lever (point 1) to secure the position

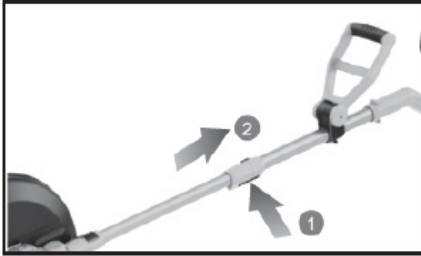

Point 1 - Open

Point 1 - Closed



FITTING THE FRONT HANDLE

1. Push the two locking buttons in together at the same time

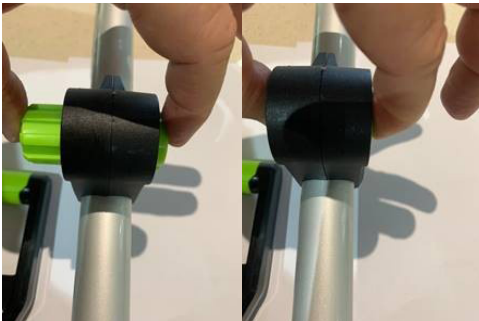

2. Place the front handle over the front mounting point (This is a very tight fit).



3. Once the handle is in position the green locking button with move out to lock the handle into position.

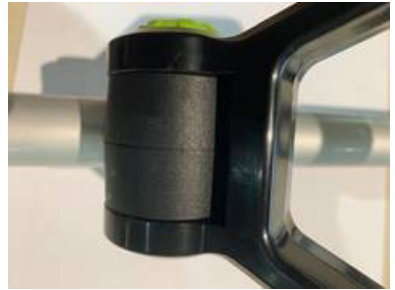

4. The front handle has 8 locking positions, to adjust press in the green locking button and move the handle to the required position. Once the front handle is in the required position release the green button and move the handle slowly until it clicks into the locking point and the green button will move out.



5. The front hand has 8 locking positions:

POSITION 1

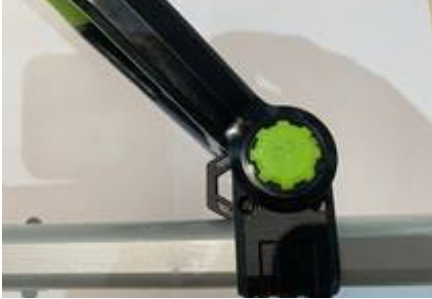

POSITION 2



POSITION 3



POSITION 4



POSITION 5



POSITION 6



POSITION 7



POSITION 8



ASSEMBLY

IN THE BOX

1. ADJUST THE CUTTING HEAD

- When you take the Line Trimmer body out of the box, the cutting head will need to be tilted back to make assembly easier.
- Press the button to lower and straighten the cutting head.



2. ATTATCH THE GUARD

- Slide the guard into the cutting head, align the locking slots on the trimmer line guard to the motor head (image 1) then slide into position (image 2)
- Ensure all screw holes align. Secure the guard by inserting and tightening two screws (image 3)

IMAGE 1



IMAGE 2

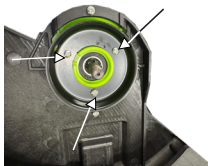

IMAGE 3



3. INSTALL THE BLADE PROTECTOR

- Place the blade protector onto the cutting head, aligning the screw holes. Ensure access to the locking hole.
- Fasten it with three silver screws.



4. FITTING THE NYLON HEAD

- Place the B plate over the shaft located at the head of the Line Trimmer



- With the Line Trimmer head facing upwards the locking hole will be to the right side, turn the B plate until you see a clear hole showing no green nylon housing



- Once the locking hole has been located place a screwdriver into the hole this will lock the motor shaft and allow the nylon trimmer head to be screwed onto the motor shaft, make sure the nylon trimmer head is firmly screwed down onto the B plate before removing the screwdriver from the locking hole.



2. Remove any nylon line that is still in the nylon head by pulling the nylon line from the bump knob:
 - First press in the tap on the side of the nylon head and rotate the top cover anticlockwise.



- Then push the Nylon line in towards the centre of the nylon head, by doing this will push the nylon line up from the centre knob of the nylon head, then remove the remaining nylon line from the nylon head spool.

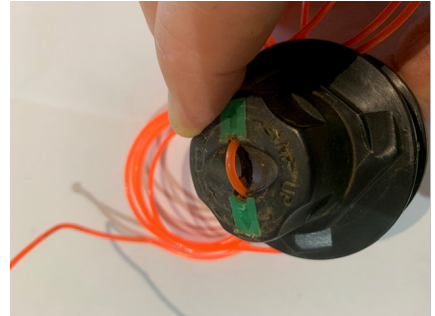

3. To reassemble the nylon head (image 1) place the spool inside of the nylon head body (image 2)

IMAGE 1



OPERATION

WARNING: Always use two hands to operate the product. Hold the rear handle with the right hand and the front handle with the left hand. Beware of objects thrown by the Nylon Trimmer Head. Remove debris like small stones, gravel, and other foreign objects from the work area before starting operation. Wires or string may become entangled with the Nylon Trimmer Head.

1. Insert the battery pack until the latches click into place. Hold the lock-out trigger (refer to page 5 item 10) and squeeze the on/off trigger (refer to page 5 item 6) to turn on the product.

WARNING: Keep hands and feet away from the Nylon Head at all times and especially when turning on the motor.

2. Use the Line Trimmer along sidewalks, driveways, flower beds, curbs, and similar areas that require edging or trimming.

NOTE: Trim at a steady pace. If the nylon head begins to slow down, you are trimming too fast; slow your pace. Do not force the nylon head into the grass.

REPLACING THE NYLON LINE

1. Remove the battery pack from the Line Trimmer (Push the button down at the back of the battery pack and slide the battery out from the Line Trimmer).

IMAGE 2



- Place the top cover over the body of the nylon head, make sure to line up the three slots that are positioned around the body of the nylon head, once in position turn the top cover clockwise until you hear a click, which indicates the top cover is locked into position.



- Then turn the centre knob at the top of the nylon head so the green arrows are pointing to the nylon head eyelets.



4. Cut two metres of new nylon line and place each end into the two holes located at the top of the centre knob until the line comes through the two eyelets (image 1), pull the nylon line through evenly so the same length of line is the same on both sides (image 2 and 3), then turn the centre knob anticlockwise until there is 10cm of nylon line out both eyelets (image 4).

IMAGE 1



IMAGE 2

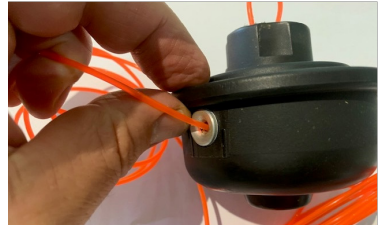
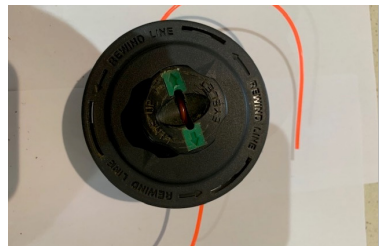

IMAGE 3



IMAGE 4



LawnMaster®

FIND US



www.lawnmaster.co.nz



lawnmasternz

Steelfort

500 Rangitikei Street, Private Bag 11045
Palmerston North, 4412, New Zealand
06 350 1350

Steelfort Auckland

880 Great South Road, Penrose
Auckland, 1061, New Zealand
09 573 1324

Steelfort Christchurch

21 William Lewis Drive, Sockburn
Christchurch, 8042, New Zealand
03 324 2480