

LawnMaster®

SAFETY AND OPERATING MANUAL

LITHIUM 58V LINE TRIMMER



LB60001S

IMPORTANT

It is essential that you read the instructions in this manual before operating this machine. All notes and images are subject to technical modification.

READ FIRST BEFORE USE! **LAWNMASTER LITHIUM BATTERY INSTRUCTIONS**

1. Battery must be fully charged before initial use.
2. Regularly letting the battery discharge below 15% may cause damage to the battery.
3. If the unit stops for an unknown reason, do not operate the unit without proper inspection. Firstly fully recharge the battery if the battery is below 15%. Secondly remove the battery and check the unit to see if there are any obstructions.
4. Allow the battery to cool before placing the unit on charge.
5. Do not store the battery for a long period of time without fully recharging battery.
6. If battery has a temperature above 38°C let the battery rest and cool before use
7. Lithium batteries do not need to be fully discharged before recharging.

GENERAL SAFETY WARNINGS

Please follow all instructions and warnings as directed in this manual to avoid electrical shock, fire and/or serious injury.

Please keep this document safe for future reference.

LINE TRIMMER USE

The 58V Line Trimmer is designed for trimming grass, trimming small weeds, ideal for small to medium residential backyards.

Two handed operation is advised at all times.

The cutting plane should be parallel to the ground at all times. The unit should not be used for trimming hedges, bushes and other vegetation that requires abnormal cutting paths away from the ground surface.

SAFE OPERATING PRACTICES

1. TRAINING

- a) Read all instructions carefully.
- b) Be familiar with the controls and use.
- c) The operator is responsible for any accidents and hazards during operation.

2. PREPARATION

- a) Before using the unit, inspect for damage, missing parts or misplaced guards/ shields.
- b) Do not operate the unit close to people, children, and or pets.

3. OPERATION

- a) Wear appropriate safety clothing such as eye protection, long trousers and sturdy footwear when operating the unit.
- b) Avoid using the unit in wet weather.
- c) Only operate the unit during the day.
- d) Do not operate the unit with damaged guards or shields.
- e) Keep your hands and feet away from the cutting head at all times during operation.
- f) Disconnect battery from the unit:
 - 1) When the unit is left unattended;
 - 2) Clearing any blockage;
 - 3) Inspecting, cleaning or working on unit
 - 4) After striking an object;
 - 5) If unit starts vibrating abnormally.
- h) Keep vent openings clear of debris.
- i) Do not bump cutting head on the ground.
- j) Do not run when operating the unit
- k) Keep the unit away from any hazards.

WARNING

Do not bump or hit cutting head on any surface, as this will damage the motor on the cutting head and will void warranty.

4. MAINTENANCE AND STORAGE

- a) Disconnect the unit from the battery before inspecting the unit, working or undertaking general cleaning work.
- b) Only genuine LawnMaster parts and accessories must be used for repairs and maintenance for warranty purposes.
- c) Inspect and maintain the unit regularly.
- d) Unit must be repaired only by an authorised LawnMaster Service Agent for warranty purposes.
- e) Keep the unit stored in a safe area, away from the reach of children.

ADDITIONAL SAFETY WARNINGS

WORK AREA

- 1) Keep work area clean and well lit.
- 2) Do not operate the unit in hazardous areas such as flammable liquids, gases and or dust.
- 3) Battery powered products can create sparks that may ignite dust or fumes
- 4) Keep children and bystanders away during operation.

ELECTRICAL SAFETY

- 1) Do not modify the product or battery.
- 2) Do not modify the battery connection or use any other adapters and or plugs.
- 2) Avoid body contact with earthed or grounded surfaces such as pipes and radiators to reduce risk of of electric shocks.
- 3) Do not expose or operate the unit in wet weather conditions as water increases the risk of electric shocks.

PERSONAL SAFETY

- 1) Always stay alert and use common sense when operating the unit. Do not use the unit when you are tired or under the influence of drugs, alcohol or heavy medication as this may result in serious personal injury.
- 2) Always wear protective clothing and equipment including eye protection, sturdy shoes, and hearing protection to reduce the chance of personal injuries.
- 3) Ensure the unit is switch off before connecting the battery, picking up or carrying the unit.
- 4) Do not overreach and wear appropriate foot wear when using the unit.

- 5) For cutting ease and safety, approach the weeds being cut from the right to the left. In the event an unexpected object or woody stock is encountered, this practice could minimize the blade thrust reaction.
- 6) Both hands must be used at all times to control this product.

TRANSPORTATION & STORAGE

- 1) Stop the unit and allow it to cool before storing or transporting. Do not store or transport the unit with the batteries fitted.
- 2) Clean all foreign material from the product and store in a cool dry and well-ventilated area away from the reach of children.
- 3) Keep away from corrosive agents such as garden chemicals and de-icing salts.
- 4) Do not store the unit outdoors.
- 5) Secure the unit during transportation to prevent injury or damage to the unit.

MAINTENANCE

- 1) Use only genuine LawnMaster replacement parts and accessories. Failure to do so can cause possible injury, poor performance and may void warranty. Servicing requires extreme care and knowledge by a qualified technician.
- 2) For service requirements please take your product to your nearest LawnMaster Agent.
- 3) Remove the battery from the unit when undertaking simple cleaning/ maintenance.
- 4) When extending the cutting line, always return the product to its normal state before starting the unit.
- 5) Clean the product with a soft dry cloth after use.
- 6) Inspect the unit regularly and check all nuts, bolts and screws for proper tightness to ensure the unit is in safe working condition.

RISK REDUCTION

The LawnMaster 58V product range has a low level of vibrations. However, it is still important to take precautions when operating cordless powertools for long periods of time. It has been identified that vibrations from hand-held powertools may contribute to a condition called Raynaud's Syndrome.

Identified symptoms include tingling upon exposure to cold. Other factors that also contribute to the development of these symptoms include health and dietary factors, smoking and general work place practices.

There are measures that can be taken by the operator to reduce the effects of vibration:

- 1) Keep body warm in cold weather conditions during operation.
- 2) Wear gloves to keep the hands and wrists warm during operation.
- 3) Exercise to increase blood circulation after operating the unit.
- 4) Take frequent work breaks and limit the amount of exposures per day.

If you experience any symptoms, immediately stop working and consult your local doctor or physician.

PRODUCT & WARNING SYMBOLS



Safety alert



Read and understand all instructions before operating the product, follow all warnings and safety instructions.



Wear safety gear for protection.



Wear non-slip safety footwear when using the product. Wear non-slip, heavy duty gloves.



Do not expose to wet weather conditions.



This unit is not intended for use with a toothed saw type blade.



Beware of thrown or flying objects. Keep all bystanders, especially children and pets, at least 15m away from the operating area.



Keep hands away from trimming line.



Beware of noise. The The guaranteed sound power level is shown on this label by 95 dB for Lawn Trimmer.



Pull: Quick release tab



Waste electrical products should not be disposed of with household waste. Please recycle where facilities exist. Check with your local authority or retailer for recycling advice.



Conforms to all regulatory standards in the country in the EU where the product is purchased.



GOST-R Conformity.



Parts or accessories sold separately.



Waste, electrical products should not be disposed with household waste. Please recycle.

UNPACKING - LINE TRIMMER

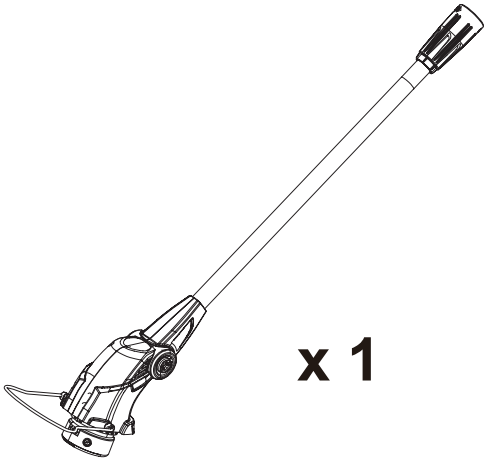

x 1

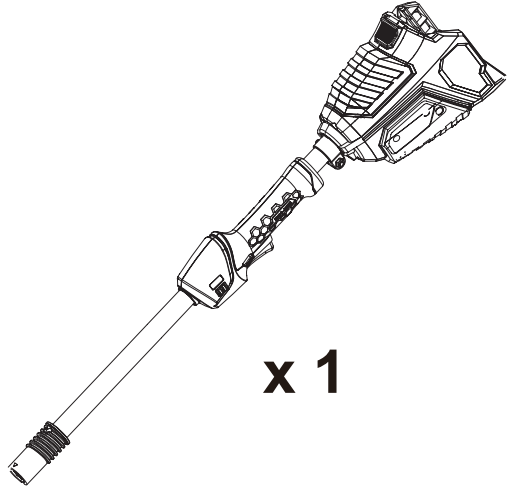

x 1

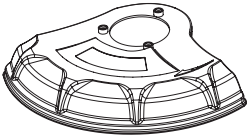

x 1

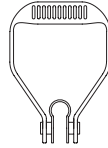

x 1

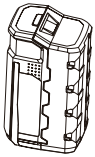

x 1

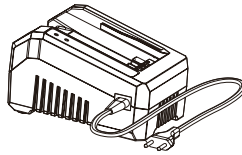

x 1



x 1



x 3



x 1

UNPACKING - LINE TRIMMER

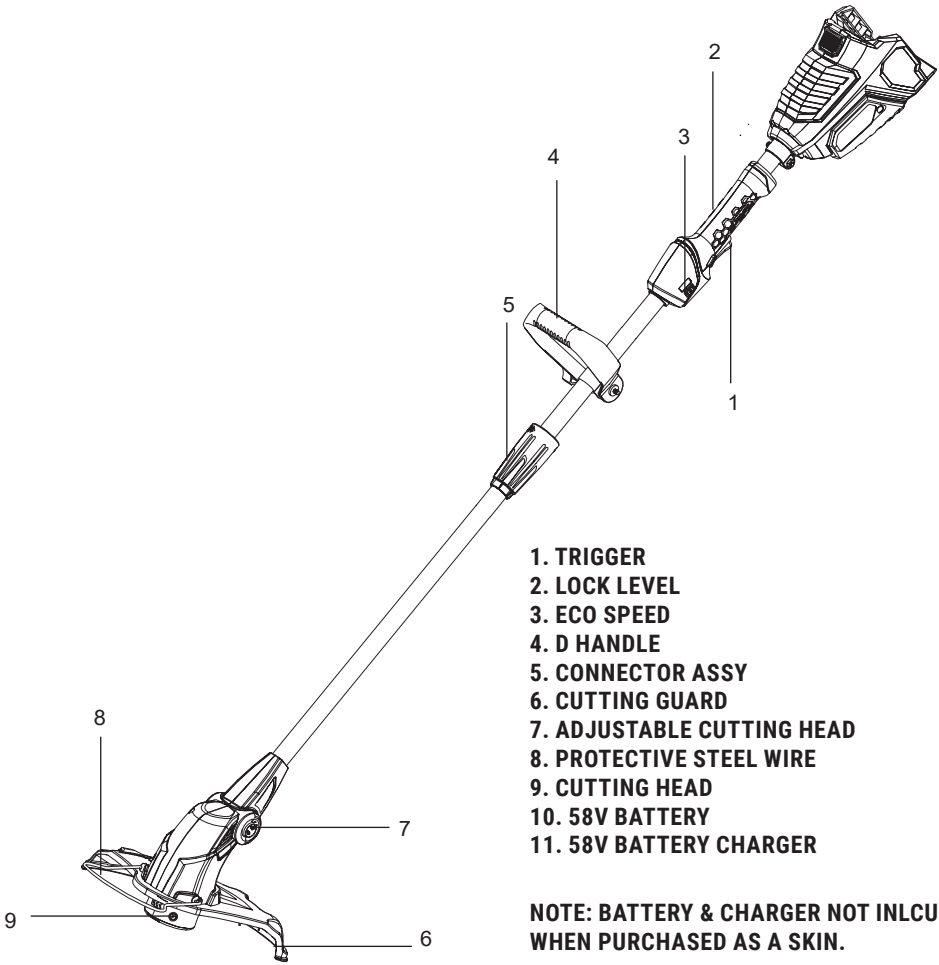

- 1. TRIGGER
- 2. LOCK LEVEL
- 3. ECO SPEED
- 4. D HANDLE
- 5. CONNECTOR ASSY
- 6. CUTTING GUARD
- 7. ADJUSTABLE CUTTING HEAD
- 8. PROTECTIVE STEEL WIRE
- 9. CUTTING HEAD
- 10. 58V BATTERY
- 11. 58V BATTERY CHARGER

NOTE: BATTERY & CHARGER NOT INLCUDED WHEN PURCHASED AS A SKIN.

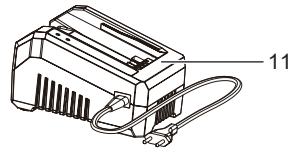
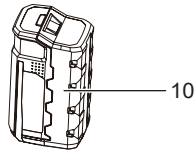

GETTING STARTED

1

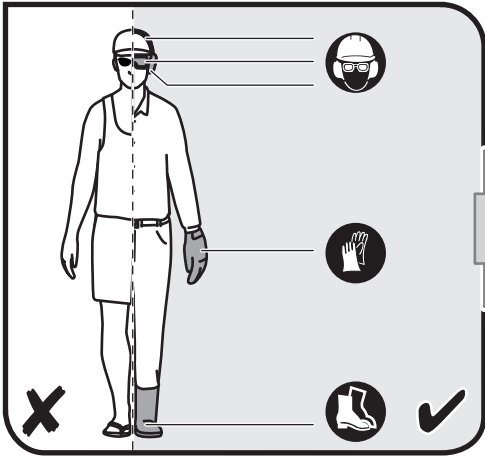

2a

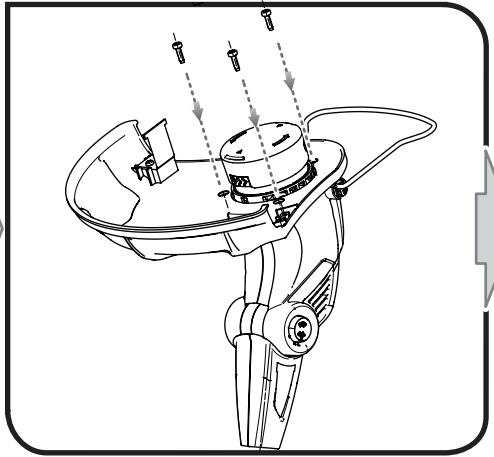

3

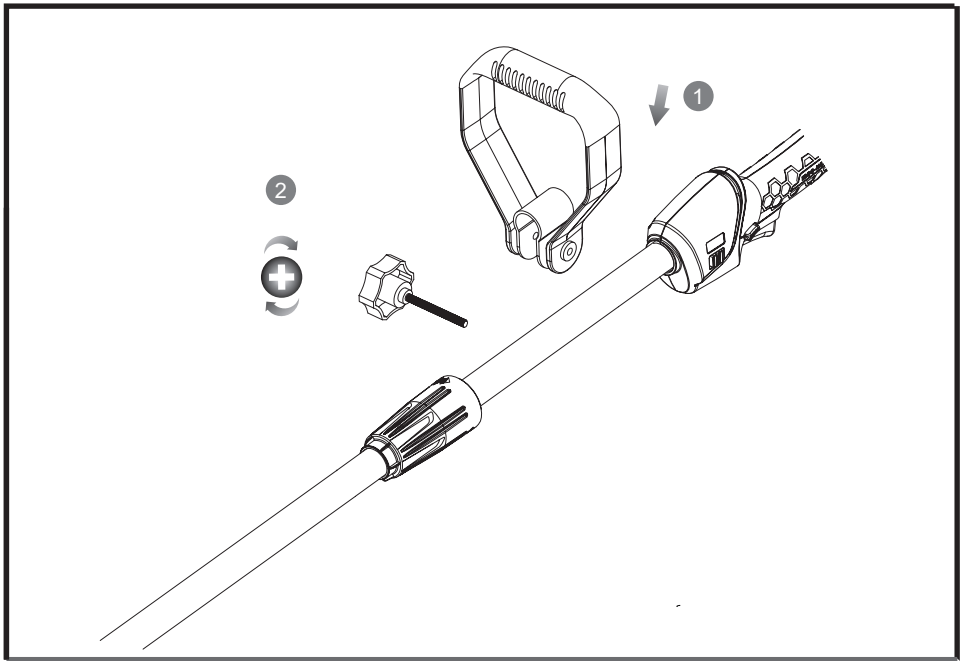

GETTING STARTED

3

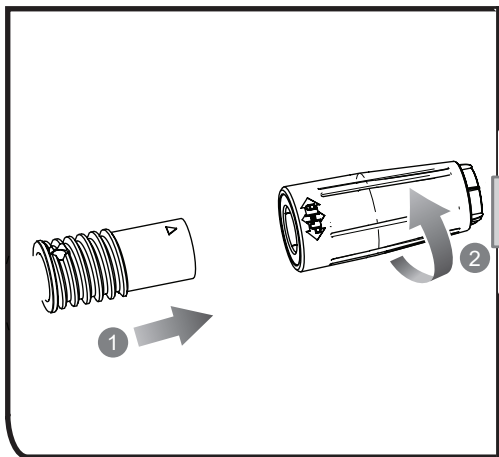

4

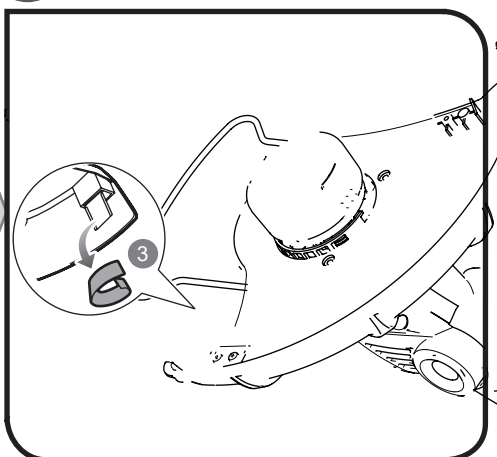

5

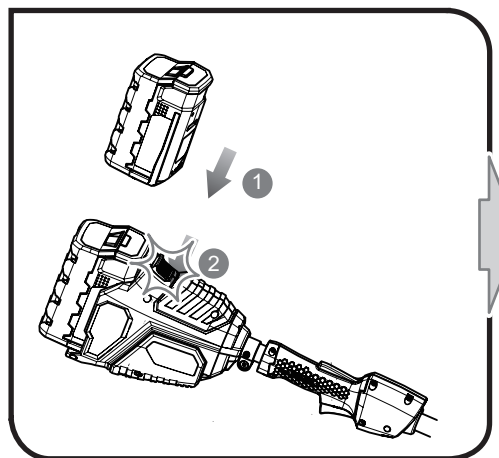

6

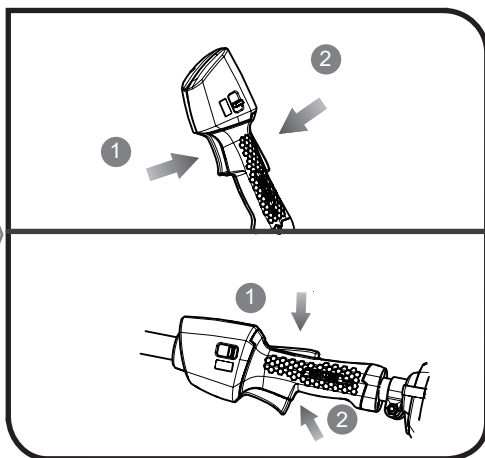

OVERVIEW & OPERATION

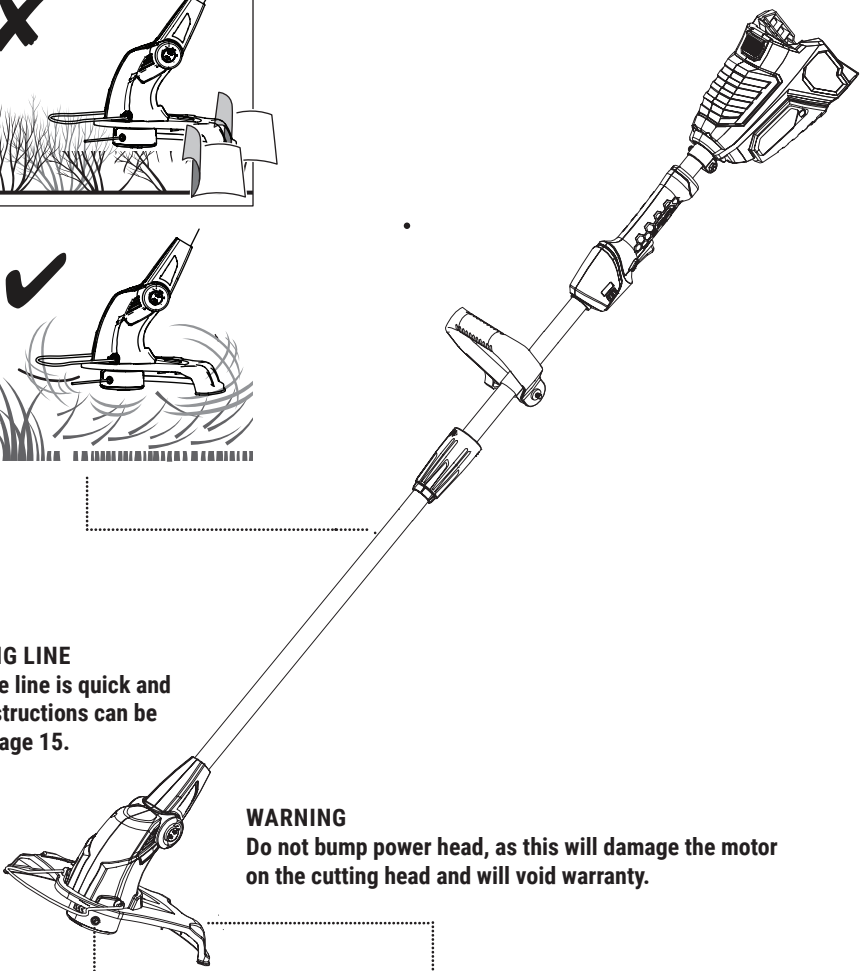
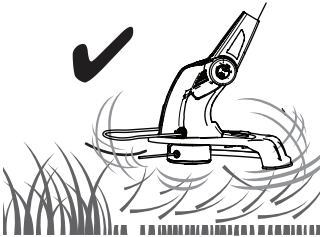
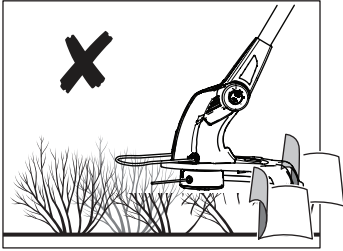

REPLACING LINE

Replace the line is quick and simple. Instructions can be found on page 15.

WARNING

Do not bump power head, as this will damage the motor on the cutting head and will void warranty.

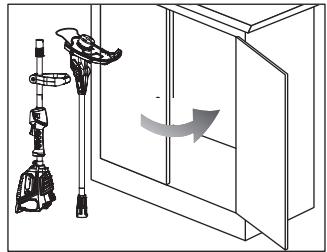
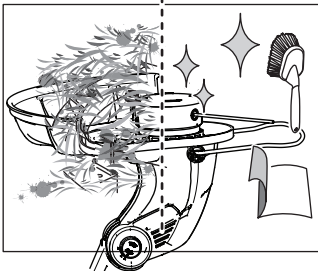
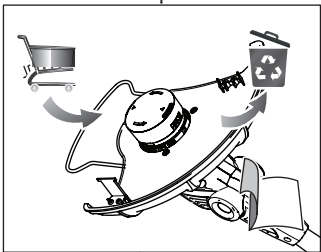

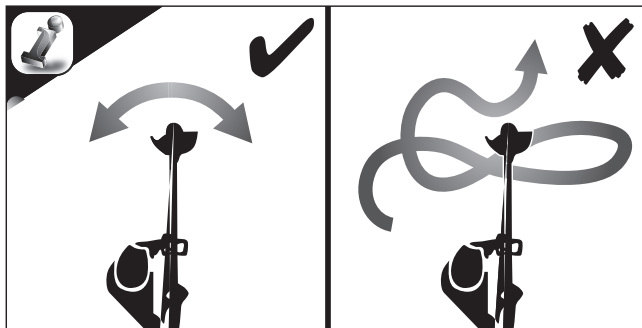
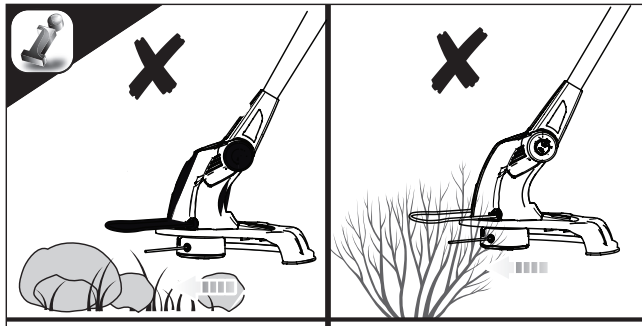
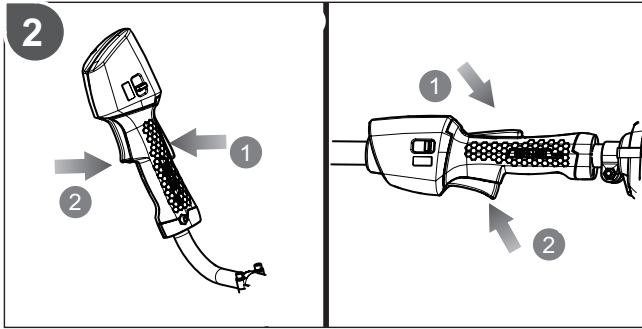
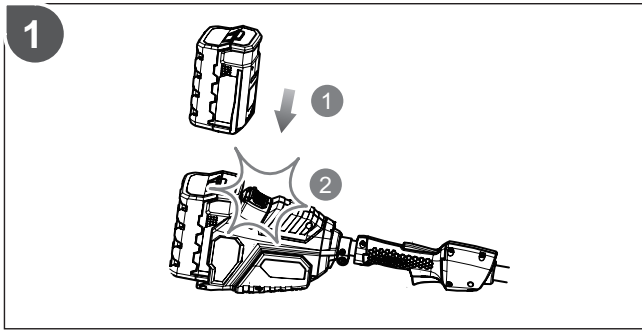

OPERATION

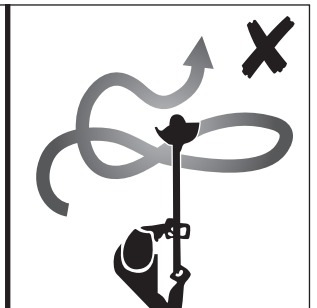
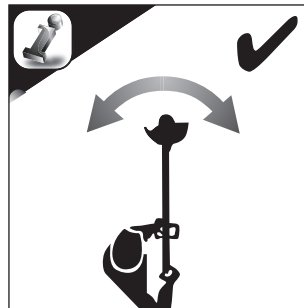
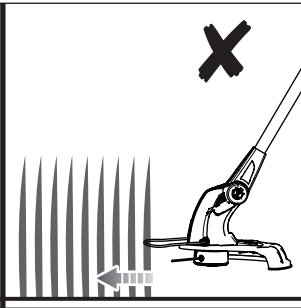
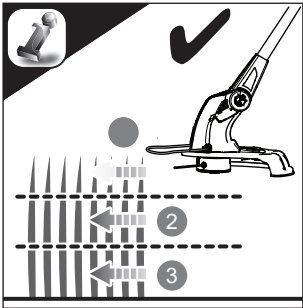
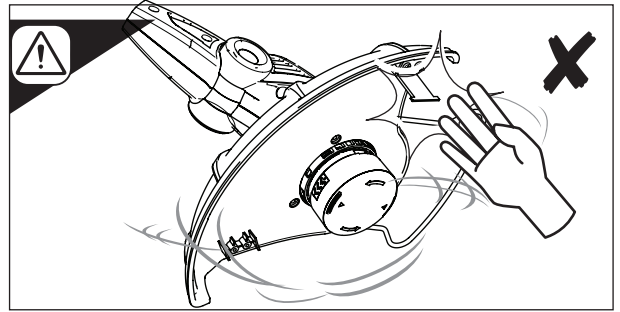
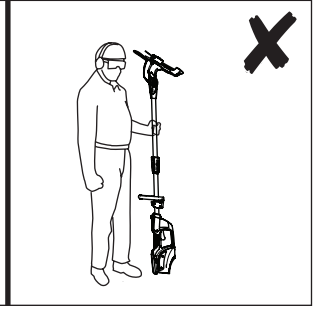
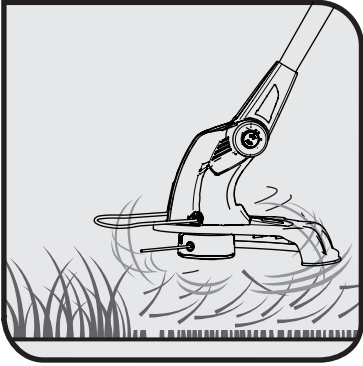

MAINTENANCE

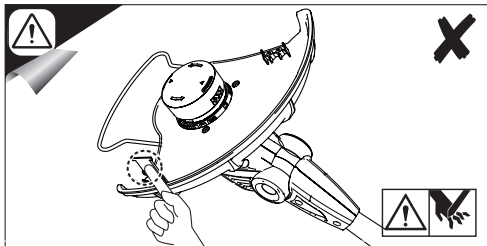
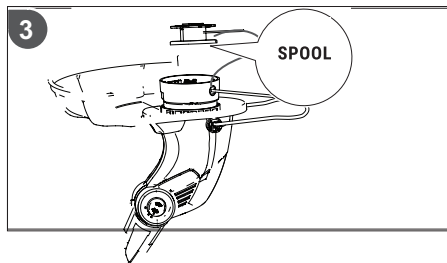
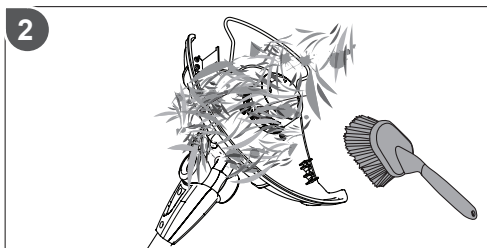
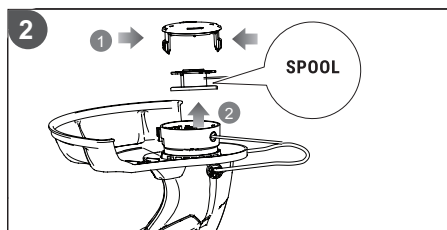
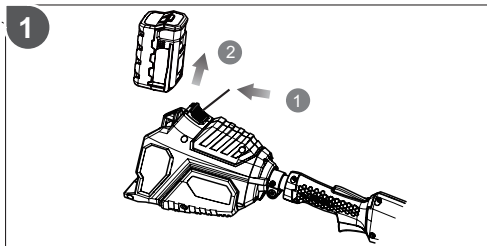
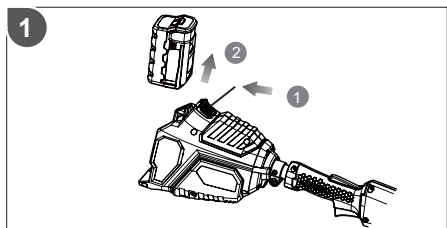
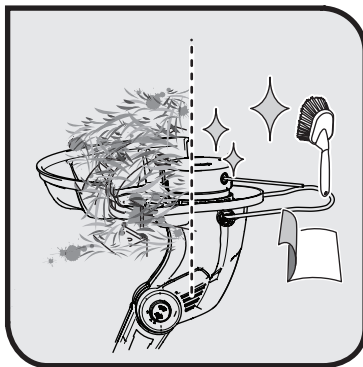
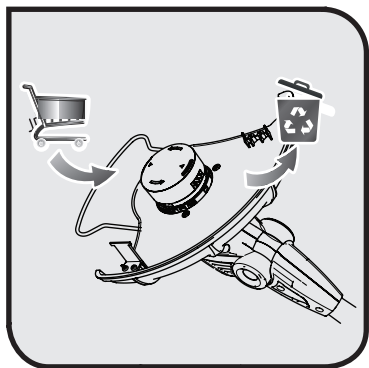

MAINTENANCE & STORAGE

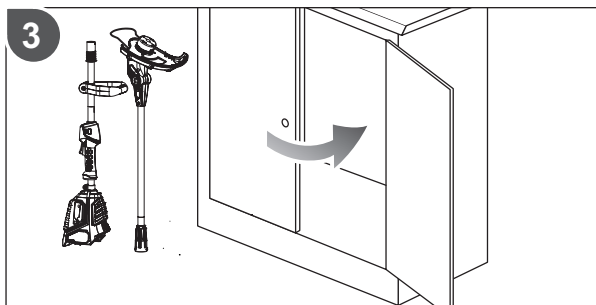
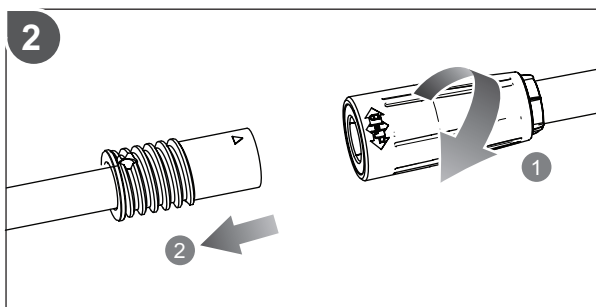
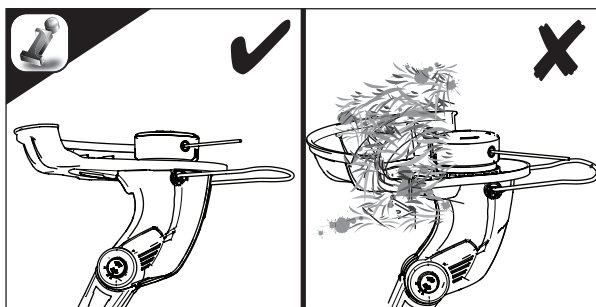
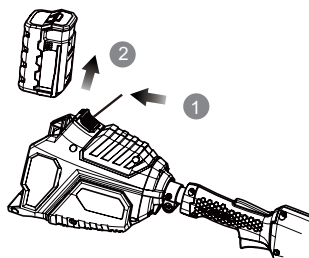
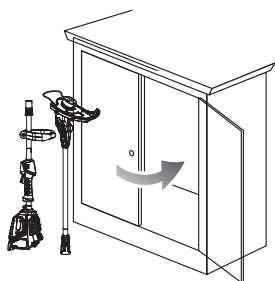

BATTERY & CHARGER

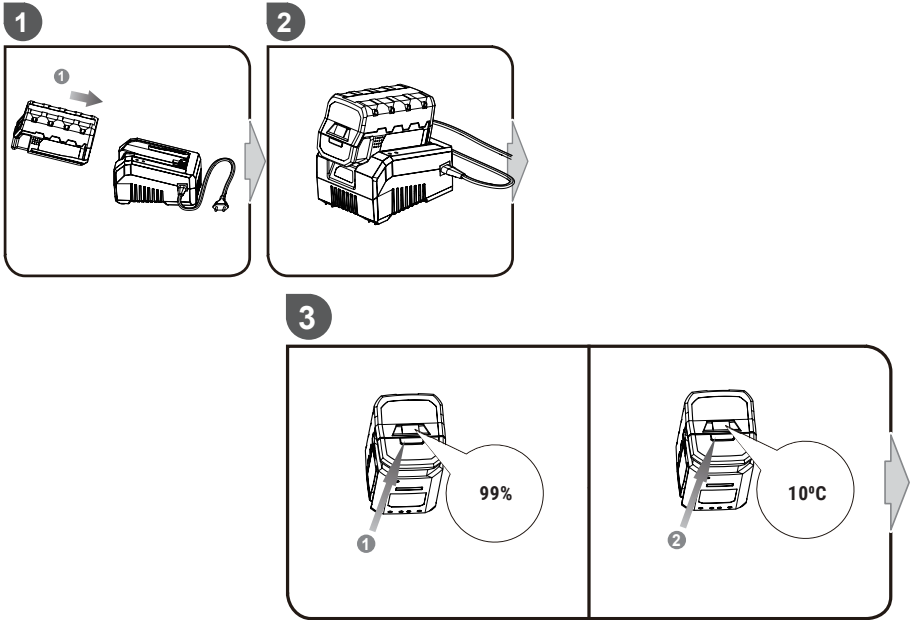

REPLACING LINE ON SPOOL



- 1 Remove the spool cover and take out the spool from housing.

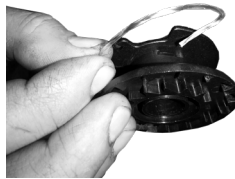

- 2 Cut roughly 1.5m of new line to insert into the spool. Hooking the end of the new line into the groove of the spool.

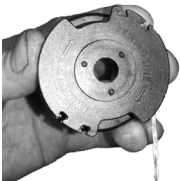

Wind the new line clockwise in the stated direction on the plastic spool. Leave roughly 20cm of line for cutting.

3



Put the excess 20cm cutting line through the plastic housing eyelit. Attach spool and place the cover over the spool to complete the process.

4

PRODUCT SPECIFICATIONS

Model:	LB060001S
Voltage:	58V DC
No-Load Speed	9000 min -1
Cutting Line Diameter:	1.65 mm
Cutting Capacity	Adjustable 260 or 305mm

Recommended Torque For
Line Retention: > 11 N.m

Recommended Torque For
String Head Retention: > 6 N.m

Vibration level (in
accordance with EN 786
Annex D) < 3.5 m/s²
Uncertainty of Measure < 1.5 m/s²

A-weighted sound level 82dB(A)
Uncertainty of Measure < 1.5 m/s²

Weight (No Battery) 3.3 KG

BATTERY

Compatible battery	LB40B
Weight	1.1 KG
Compatible charger	LB40BCKT
Battery & Charger	LB4050002KIT

WARRANTY

This product has 3 year warranty. This warranty covers damages and bad function, only if the product has not been misused and all the instructions has been correctly followed.

In order to claim warranty, a receipt must be presented and returned to the retail outlet. The product has to be complete and have all its parts. Warranty does not cover wear, lack of maintenance, negligence, incorrect assembly and inappropriate usage (blows, disrespect to power supply, storage, using conditions, etc). Warranty will be void for all non-original parts accessories used on the product.

If the unit requires further repairs or service, visit www.steelfort.co.nz to find your nearest service dealer.

LawnMaster

Steelfort

500 Rangitikei Street
Private Bag 11045
Palmerston North, 4442, New Zealand
06 350 1350 | steelfort.co.nz

Steelfort Auckland

880 Great South Road, Penrose
Auckland, 1061, New Zealand
09 573 1324 | outlet@steelfort.co.nz



SCAN TO VIEW THE
LAWNMMASTER RANGE

