

LAWNMOWER

LawnMaster 58 V 18" Lithium Fusion

LawnMaster

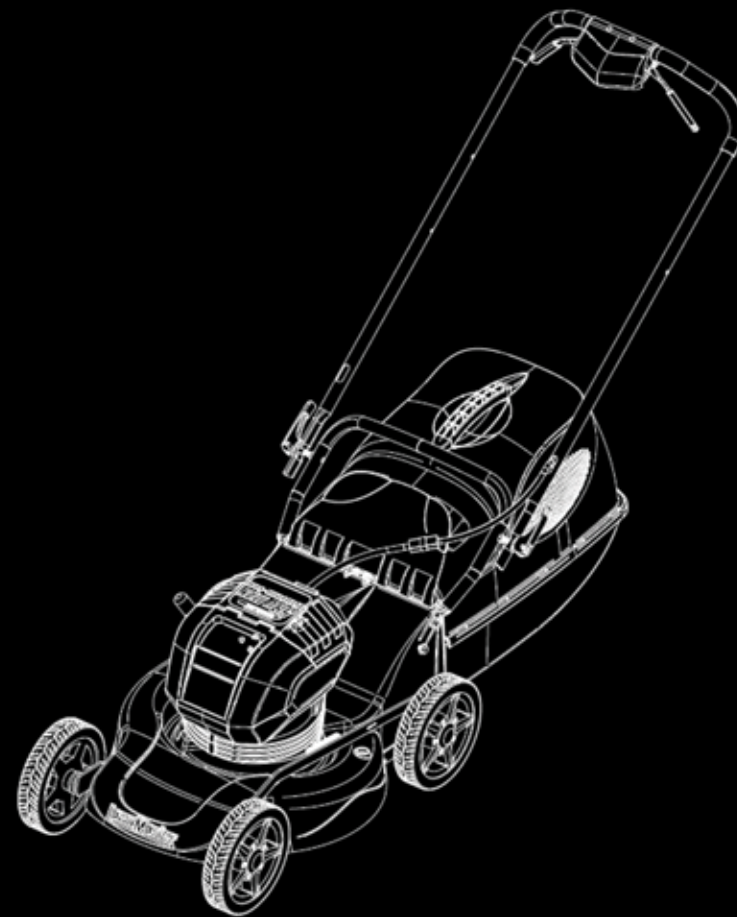

READ FIRST BEFORE USE!

LawnMaster Lithium Battery Instructions

1. Battery must be fully charged before initial use.
2. Never let the battery discharge below 15% - discharging below 15% may cause damage to the battery.
3. Do not continue use if machine stops - fully recharge battery first if below 15%. If above 15% assess tool for potential obstructions.
4. We recommend to fully recharge the battery immediately after every use.
5. Do not store for a long period without fully recharging battery.
6. Check battery temperature (press button twice for temperature). If above 50°C let battery rest and cool.

* * *

Lithium batteries do not need to be fully discharged before recharging.

GUARANTEE

Warranty

The seller warrants this rotary lawnmower to be free from defects in material and workmanship. Subject to the following conditions, the rotary lawnmower comes complete with a three-year comprehensive parts and labour warranty; with the exception of domestic mowers being used for commercial, institutional, industrial, rental or income producing purposes which are limited to 90 days of warranty. Additionally, the rotary lawnmowers come with a lifetime warranty on the alloy chassis only.

- 1 This warranty does not include the engine and batteries (if fitted), which are covered by separate manufacturers warranties.
- 2 This warranty excludes normal wear and tear, misuse, neglect, accidental damage or defects arising from failure to comply with the instructions as outlined in this Owners Manual. Wearing parts such as blades, blade bolts, belts and spark plugs, which can be subjected, to use beyond their normal working capacity are also excluded.
- 3 This warranty is void if parts other than genuine spare parts have been used or if repairs have been carried out by other than authorized Service Agents.
- 4 This warranty does not cover the costs of transportation of any part(s) but does cover the labour / part costs incurred in repairing or replacing any defective part(s).
- 5 The seller reserves the right to inspect any faulty part(s) in order to determine the validity of the warranty claim or for any other reason.
- 6 The seller has no liability for any incidental, consequential or special damages and / or expenses resulting from any defect in their product.

These conditions do not affect the purchasers' statutory rights under the laws of the place, state or country of purchase. If warranty service is required, contact your nearest authorised Service Agent.

Spare Parts



**Use only genuine LawnMaster spare parts to ensure safety/performance.
Substitute parts can be dangerous and will invalidate the warranty.**

When ordering spare parts, please give the following information:

- PART NUMBER.
- DESCRIPTION AND QUANTITY REQUIRED.
- MACHINE TYPE/MODEL.
- BATCH AND SERIAL NUMBER.

TRANSPORTING LITHIUM BATTERIES

Transport the battery in accordance with local and national provisions and regulations. Follow all special requirements on packaging and labelling when transporting batteries by a third party. Ensure that no batteries can come in contact with other batteries or conductive materials while in transport by protecting exposed connectors with insulating, non-conductive caps or tape. Do not transport batteries that are cracked or leaking. Check with the forwarding company for further advice.



WARNING

Not intended for use other than what is listed above.

RECYCLING AND DISPOSING

When you decide to get rid of the machine, make sure to follow the local regulation. The batteries used in this mower's battery pack contain the following toxic and corrosive material: LITHIUM-ION.



WARNING

Toxic materials must be disposed of in a specified manner in order to prevent contamination of the environment. Before disposing of damaged or worn out Lithium-Ion battery packs, contact your local waste disposal agency for information and specific instructions. Take the battery to a local recycling and/or disposal centre that is certified for disposal. If the battery pack cracks or breaks, whether it leaks or not, do not recharge it and do not use it. Dispose of it and replace it with a new battery pack. **DO NOT ATTEMPT TO REPAIR IT!**

Follow these instructions in order to avoid injury and the risk of fire, explosion, or electric shock, and to avoid damage to the environment:

- Cover the battery's terminals with heavy-duty adhesive tape.
 - Do not attempt to remove or destroy any of the components of the battery pack.
 - Do not attempt to open the battery pack.
 - If a leak develops, the electrolytes that are released are corrosive and toxic. Do not get the solution in the eyes or on the skin, and do not swallow it.
 - Do not place batteries in regular household trash.
 - DO NOT incinerate batteries.
 - DO NOT place batteries where they will become part of any waste landfill or municipal solid waste stream.
 - Dispose of batteries at a certified recycling or disposal center.
- Package materials are recyclables. Please, throw them away in the appropriate trash can.



INDEX

INTRODUCTION	4
SAFETY RULES AND PRECAUTIONS	4
SAFETY ADVICE FOR RECHARGEABLE BATTERY AND CHARGER	7
CHILD SAFETY	8
WARNING SYMBOLS	9
PRODUCT DESCRIPTION	10
DETAILED DESCRIPTION OF THE PRODUCT	10
TECHNICAL DATA	11
ASSEMBLY	12
UNPACKING	12
HANDLEBAR FOLDING INSTRUCTIONS	14
ASSEMBLING THE CATCHER	14
INSTALLING THE GRASS CATCHER FITTING &	15
REMOVING THE MULCHER PLUG	15
BATTERY PACK INSTALLATION & REMOVAL	16
BLADE CARE/ASSEMBLY	17
USING THE PRODUCT	18
STARTING/STOPPING THE MOWER	18
CUTTING HEIGHT ADJUSTMENT	18
SLOPE GAUGE	19
MOWING TIPS	20
MULCHING TIPS	20
BATTERY AND CHARGER	21
CUTTING BLADE ADJUSTMENT	22
GRASS CATCHER	22
CARE AND MAINTENANCE	
CLEANING THE MOWER BODY	23
EMPTYING THE GRASS CATCHER	24
SERVICE AND ADJUSTMENTS	25
TRANSPORTING LITHIUM BATTERIES	26
RECYCLING AND DISPOSING	26
GUARANTEE	27
WARRANTY	27
SPARE PARTS	27



INTRODUCTION

Thank you for choosing this LawnMaster product. We are sure you shall appreciate the quality and performance of this machine.

Remember that you can contact our Technical Support for any queries regarding assembly or maintenance, as well as for the resolution to any problems that may arise, and for the purchase of spare parts and/or accessories.



WARNING

Please read these Operating Instructions carefully as well as the safety precautions before using your device. Failure to do so could result in an electric fault, fire hazard and/or in personal injury. The manufacturer will not take responsibility for accidents or injuries caused to the user, third parties or objects as a result of not following the instructions in the user manual.



WARNING

This machine must only be used to mow lawns. Do not attempt to use this machine for other purposes for which the machine is not intended for, such as to clear land, for leaf or debris collection, to trim hedges, pruning bushes or for cutting vegetation other than grass. Do not use this machine as a crushing machine. Using the lawnmower for other purposes the machine is not intended for may lead to dangerous situations.

This machine is not intended for professional use.

Keep this user manual safe for future reference. Should you sell this machine in the future, please remember to hand this manual to the new owner.

SAFETY RULES AND PRECAUTIONS

The aim of the following warning signs and their meaning is to explain the levels of risk related to this product.

SYMBOL	SIGN	MEANING
	WARNING	It indicates a dangerous situation where you need to pay full attention to avoid any kind of personal injuries or damage to the device.
	NOTICE	It indicates useful information which can facilitate your task.



WARNING

Please read all safety warnings and instructions. Not doing so may result in electrical shocks, fire, or in severe personal injuries.

SERVICE AND ADJUSTMENTS

- Identical replacement parts are available from the manufacturer. In order to obtain replacement parts, the use of parts that do not meet the original equipment specifications may lead to improper performance, and may compromise safety.
- Before cleaning, repairing, or inspecting, verify that the blade and all moving parts have come to a complete stop. Remove the battery when making any adjustments or when any of the four wheels must be lifted off the ground.
- Keep the handles dry, clean, and free of oil and grease.
- In order to reduce the risk of fire, keep the motor free of grass, leaves, and debris build-up.
- Check the blade and motor mounting bolts for proper tightness frequently. Visually inspect blade for damage (e.g., bent, cracked, or worn).
- For best and safest performance, maintain the mower with care. Keep the mower blade sharp and clean. Mower blades are sharp, and can cut. Wrap the blades or wear gloves, and use extra caution when servicing.
- Keep all nuts, bolts, and screws tight in order to be sure that the equipment is in safe working condition.
- Never tamper with safety devices. Check them regularly for proper operation.
- After striking a foreign object, stop the motor. Thoroughly inspect the mower for any damage. Repair any damage before operating the mower.
- The grass catcher components, discharge cover, and trail shield are subject to wear and damage, which could expose moving parts or allow objects to be thrown. As a safety precaution, check these components frequently, and immediately replace any parts that show signs of wear, or that are cracked or broken. Use original equipment manufacturer's parts only.
- When it is not in use, store the mower indoors in a dry area, and out of the reach of children.

PROBLEM	POSSIBLE CAUSE	SOLUTION
The mower does not start.	The battery is not charged.	Charge the battery.
	The switch is defective.	Replace the switch.
	Grass jammed between the deck and blade.	Remove battery; check under deck for jams.
	The battery is not fully inserted in the mower. Battery may require service or replacement.	Check the connection between the battery and the mower. Make sure the battery clicks into place. Replace battery.
The mower cuts the grass unevenly.	The lawn is rough or uneven.	Check the mowing area.
	The cutting height is not set properly.	Move the wheels to a higher setting.
The mower does not mulch properly.	Wet grass clippings are sticking to the underside of the deck.	Wait until the grass dries before mowing.
	The mulching plug is missing.	Install the mulching plug.
The mower is hard to push.	The grass is too tall, or the cutting height is too low.	Raise the cutting height.
	The rear of the grass catcher bag is dragging in thick grass.	Empty the grass clippings from the grass catcher bag.
The mower is excessively noisy and vibrates.	The motor shaft is bent.	Stop the motor, and inspect for damage.
	The blade is unbalanced.	Repair before restarting.

EMPTYING THE GRASS CATCHER

- Stop mower, allow blades to completely stop.
- Lift the rear flap
- Lift the grass catcher by its handle to remove from mower.
- Empty grass clippings.
- Lift the rear flap and reinstall the grass catcher as described earlier in this manual.

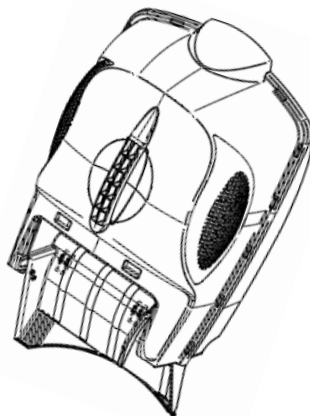

The purpose of the safety rules is to attract your attention to possible dangers. The safety symbols and the explanations with them, require your careful attention and understanding. The safety warnings do not by themselves eliminate any danger. The instruction or warnings they give are not substitutes for proper accident prevention measures.



WARNING

Failure to obey a safety warning can result in serious injury to yourself or to others. Always follow the safety precautions to reduce the risk of fire, electric shock and personal injury. Save owners manual and review frequently for continuing safe operation and instructing others who may use this tool.



WARNING

This machine produces an electromagnetic field during operation. This field may under some circumstances interfere with active or passive medical implants. To reduce the risk of serious or fatal injury, we recommend persons with medical implants to consult their physician and the medical implant manufacturer before operating this machine.



WARNING

The operation of any tool can result in foreign objects being thrown into your eyes, which can result in eyes being severely damaged. Before beginning power tool operation, always wear safety goggles or safety glasses with side shields and a full face shield when needed. We recommend Wide Vision Safety Mask for use over eyeglasses or standard safety glasses with side shield.



WARNING

Always remove battery when servicing or transporting the mower.

1. Read the instructions carefully. Be familiar with the controls and the proper use of the equipment.
2. Never allow children or people unfamiliar with these instructions to use the lawnmower.
3. Never mow while people, especially children, or pets are nearby.
4. Keep in mind that the operator or user is responsible for accidents or hazards occurring to other people or their property.
5. While mowing, always wear substantial footwear and long trousers. Do not operate the equipment when barefoot or wearing open sandals; Avoid wearing clothing that is loose fitting or that has hanging cords or ties.
6. Thoroughly inspect the area where the equipment is to be used and remove all objects which can be thrown by the machine.
7. Before using, always visually inspect to see that the blades, blade bolts and cutter assembly are not worn or damaged. Replace worn or damaged blades and bolts in sets to preserve balance.
8. Replace damaged or unreadable labels.
9. Mow only in daylight or in good artificial light.
10. Avoid operating the equipment in wet grass, where feasible.
11. Always be sure of your footing on slopes.
12. Walk, never run.
13. For wheeled rotary machines; mow across the face of slopes, never up and down.

14. Exercise extreme caution when changing direction on slopes.
15. Do not mow excessively steep slopes.
16. Use extreme caution when reversing or pulling the lawnmower towards you.
17. Stop the blades if the lawn mower has to be tilted for transportation when crossing surfaces other than grass, and when transporting the lawn mower to and from the area to be mowed.
18. Never operate the lawnmower with defective guards, or without safety devices, for example deflectors and/or grass catchers, in place.
19. Start or switch on the motor carefully according to instructions and with feet well away from the blades.
20. Do not tilt the lawnmower when starting switching on the motor, except if the lawnmower has to be tilted for starting. In this case, do not tilt it more than absolutely necessary and lift only the part which is away from the operator.
21. Do not start the motor when standing in front of the discharge chute.
22. Do not put hands or feet near or under rotating parts. Keep clear of the discharge opening at all times.
23. Never pick up or carry a lawnmower while the motor is running.
24. Stop the motor and switch off isolator key. Make sure that all moving parts have come to a complete stop.
 - whenever you leave the machine;
 - before clearing blockages or unclogging chute;
 - before checking, cleaning or working on the lawnmower;
 - after striking a foreign object. Inspect the lawnmower for damage and make repairs before restarting and operating the lawnmower;
25. If lawnmower starts to vibrate abnormally (check immediately);
 - inspect for damage.
 - replace or repair any damage parts.
 - Check for and tighten any loose parts.
26. Keep all nuts, bolts and screws tight to be sure the equipment is in safe working condition.
27. Check the grass catcher frequently for wear or deterioration.
28. Replace worn or damaged parts for safety.
29. This appliance is not intended for use by persons with reduced physical, sensory or mental capabilities, or lack of experience and knowledge, unless they have been given supervision or instruction concerning use of the appliance by a person responsible for their safety.
30. Be careful during adjustment of the machine to prevent entrapment of the fingers between moving blades and fixed parts of the machine.
31. Always allow the machine to cool before storing.
32. After use and before storage, remove the battery from the machine and check for damage.
33. When servicing the blades be aware that, even though the power source is switched off, the blades can still be moved.
34. Replace worn or damaged parts for safety. Use only genuine replacement parts and accessories.
35. Be careful during adjustment of the appliance to prevent entrapment of the fingers between moving blades and fixed parts of appliance.

CLEANING THE MOWER BODY



Do not use a water hose around the engine.

There is a direct relationship between the lawnmower's life and the care and attention given to the lawnmower, both during and after operation.

After use it is important that the lawnmower is thoroughly cleaned down and inspected so that it will be in good working order the next time it is required. Remove the battery and thoroughly clean the engine, underside of the chassis, wheels and grass catcher.

Do not use water to clean the underside of the mower.

Cleaning the catcher

Simply hose out the catcher and screen after each use to ensure maximum mower performance and catcher fill.

Cutting blade adjustment



Always remove the battery when adjusting the blade, to prevent accidental engine start.

It is essential that the relationship between the blade(s) and mower body is kept in good adjustment and that cutting edges are kept sharp to ensure good cutting performance, minimum power consumption and prolonged life for the cutting edges. Carry out the following procedures before commencing work and re-check the settings every 2 to 3 hours of mowing or when the cutting performance is noticeably reduced. During mowing, the blade tips can move relatively to the mower body through normal work or by hitting obstructions. Check that the cutting blade(s) is correctly set to the mower body by measuring the distance between the blades and the lawnmower skirt, vertically. This distance should nominally be 3mm. Remove the battery and carefully rotate the blade by hand and check that the distance is nominally correct all around the mower body. If adjustment is necessary, proceed as follows:

- Remove the battery.
- Rotate the blade(s) manually until it is accessible from the rear flap area.
- Using a crescent spanner on the end of the blade, apply an upward or downward force to correct the distance.
- Re-check each blade and make marginal adjustments as necessary.
- Re-insert the battery.

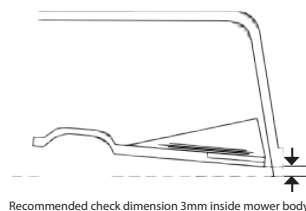

Recommended check dimension 3mm inside mower body

If it is impossible to obtain a good clean cut, it may be necessary to take the mower to your local Service Agent to have a new set of blades fitted.

Grass catcher



Always shut off the engine and ensure it has stopped before fitting and removing the grass catcher or raising the rear flap

Your rotary lawnmower can be operated with the grass catcher fitted, or removed as a utility mower.

Note that if the lawnmower is used with the catcher removed, the rear flap must be fitted and located in the down / closed position. To fit the grass catcher, stop the engine and position the catcher on the ground behind the mower. Raise the rear flap and lift the catcher into position ensuring the catcher tongue is located over the rear axle. Slide the catcher forward and upward; lower the flap so that the lugs on the flap locate into the square holes on top of the catcher. Your catcher is now attached.

To remove the grass catcher, stop the engine, hold the catcher by its top handle and raise the rear flap. Lift the grass catcher up and away from the lawnmower and return the grass flap to its down / closed position.

Avoid leaving the catcher in direct sunlight when not in use. The catcher will not deteriorate if stored wet but prolonged exposure to sunlight can cause premature UV breakdown. Dust and clippings will build up inside the catcher and on its venting screen, particularly during wet weather mowing. This debris will impede the function of the catcher so it should be removed by hosing out with water when necessary.

36. Recharge only with the charger specified by the manufacture. Using a charger with an incompatible battery pack may create a risk of fire.
37. Use power tools only with specifically designated battery packs. Use of any other battery packs may create a risk of injury and fire.
38. When battery pack is not in use, keep it away from other metal objects like, paper clips, coin, keys, nails, screws, or other small metal objects, that can make a connection from one terminal to another. Shorting the battery terminals together may cause burns or a fire.
39. Under abusive conditions, liquid may be ejected from the battery:
 - If contact accidentally occurs, flush with water.
 - If liquid contacts eyes seek medical help. Liquid ejected from the battery may cause irritation or burns.
40. When device is not in use, keep it away from other metal objects like paper clips, coins, keys, nails, screws, or other small metal objects that can make a connection from one terminal to another. Shorting the battery terminals together may cause burns or a fire.
41. This appliance can be used by children aged from 14 years and above and persons with reduced physical, sensory or mental capabilities or lack of experience and knowledge if they have been given supervision or instruction concerning use of the appliance in a safe way and understand.
42. Children should not play with the appliance.

SAFETY ADVICE FOR RECHARGEABLE BATTERY AND CHARGER

- Use only the battery provided with the lawn mower and the provided charger.
- Protect battery and battery charger from humidity.
- Do not operate the battery charger outdoors.
- When it is not in use or before cleaning and servicing, disconnect the battery charger from the power supply. Take special care of the battery.
- Avoid dropping it onto any hard surface and do not subject it to pressure or any other form of mechanical stress.
- Keep the battery away from extreme heat and cold.
- Do not open or attempt to repair the battery or the battery charger. If any parts are defective, have them repaired by a qualified technician or send them to our service department for repair.
- Only charge the battery at an ambient (surrounding air) temperature between 0°C and +50°C.
- A charged battery can be used to power the machine under ambient temperature conditions between 20°C and +70°C.
- When not in use, store the battery in a dry place between 10°C and 30°C.
- The battery should be recharged when it fails to produce sufficient power on jobs which were easily done previously. DO NOT CONTINUE using product with its battery in a depleted condition.
- The battery is not fully charged at the factory. Before attempting to use it, it must be fully charged first.

**WARNING**

Never short-circuit the battery or expose it to moisture. Do not store it together with any metal parts which could short-circuit the contacts. The battery could overheat, start burning or explode.

- If any person comes into contact with acid or similar internal fluids or substances contained in the battery, wash off these substances immediately with plenty of water. If these substances make contact with the eyes, rinse with plenty of water and visit a doctor immediately.

**WARNING**

Do not open the battery pack to get the battery out by yourself.

- Do not place the rechargeable battery into fire or water. It can explode. The rechargeable battery should not be discarded to domestic refuse, regardless of whether used or unused. You should return it to a local battery collection point in accordance with battery regulations.

CHILD SAFETY

Tragic accidents can occur if the operator is not aware of the presence of children.

- Keep children out of the mowing area and under the watchful care of a responsible adult.
- Do not allow children under the age of 14 to operate this mower. Children who are 14 years of age and older must read and understand the operating instructions and safety rules in this manual, and must be trained and supervised by a parent.
- Stay alert, and turn the mower off if a child or any other person enters the mowing area.
- Look behind and down for small children before and while moving backwards.
- Use extreme care when approaching blind corners, doorways, shrubs, trees, or other objects that may obscure your view of a child who may run into the path of the mower.

- If a trail of grass is visible, raise the cutting height of the mower.
- If the conditions for mulching are not ideal and / or there are trails of clippings visible after cutting, there are several steps that you can take. Convert your lawnmower back to catcher mode to remove some of the matted grass, re-mow over the clippings, raise the height of cut or rake up the clippings after mowing.
- It is recommended to vary the direction of mowing from week to week to prevent matting of the grass. One-week mow east to west, the next mow north to south.
- You may notice excess clippings being dropped during turning; these areas should be re-mown at the end to distribute properly.

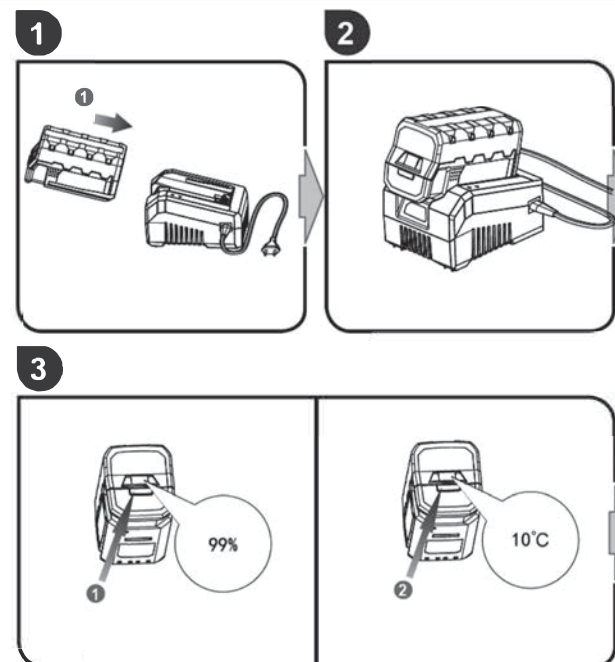
BATTERY AND CHARGER

MOWING TIPS

NOTE: A sharp blade will greatly enhance the performance of the mower, especially when cutting high grass. Be sure to check the blade and to sharpen it at least once per year, as described in the Maintenance section.

- Verify that the lawn is free of stones, sticks, wires, and other objects that could damage the blades or the motor. These objects could be accidentally thrown by the mower in any direction, and could cause serious personal injury to the operator and to others. In order to prevent electric shock, do not operate the mower in damp or wet conditions.
- Do not mow in circles. Travel back and forth across the lawn.
- When cutting thick grass, reduce walking speed in order to allow for a more effective cut and a proper discharge of the clippings.
- For a healthy lawn, always cut off one-third or less of the total length of the grass. The average lawn should be approximately 1" to 2" (2.5 to 5 cm) long during cool months, and between 2" to 3 1/4" (5 cm to 8.3 cm) long during hot months.

MULCHING TIPS



Always wait until the engine has stopped and the blade has stopped rotating before fitting or removing the mulcher plug.

Mulch mowing is recommended at the higher end of the height of cut settings to allow a good even cut and distribution of clippings through the lawn. Mulch mowing involves different mowing practices to conventional mowing and here are a few helpful guidelines to provide the best results with your mulching mower.

- Avoid mulching the lawn in wet conditions. Wet grass will build up on the inside of the body, fall off in clumps and not spread evenly into the lawn. The best time to mulch is in the late afternoon or early evening. By this time the grass is usually dry and the sensitive, newly cut grass is not exposed to the direct sunlight.
- Limit your ground speed to suit the conditions and to obtain the best finish and distribution. The slower the forward speed the better the finish.
- Do not try to mulch on a low cutting height setting. Remember the maximum cut should be 25 mm off the top of the grass or one third of the grass height, whichever is the lesser amount.
- Always mulch at maximum throttle setting. When engine speed is reduced or the workload is too much, the blades will not mulch the grass efficiently resulting in a poor quality finish.
- Keep the blades sharp for optimum mulching performance and to reduce engine power loss and speed.
- Keep the underside of the lawnmower body clean so that the airflow is not restricted. All rotary lawnmowers are fitted with a convenient wash nozzle for this purpose.

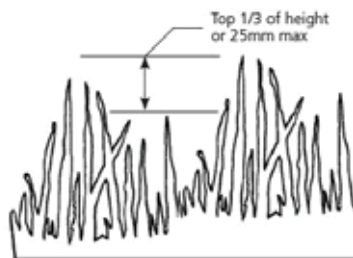

WARNING SYMBOLS

The warning icons on labels in this machine and/or in the manual indicate the necessary information for the safe use of the device.



Precautions that involve your safety.



To reduce the risk of injury, user must read and understand user's manual before using this product.



Wear hearing and eye protection.



Do not expose machine to rain or wet conditions.



Pay attention that bystanders are not injured through foreign objects thrown from the mower.



Keep all bystanders (especially children and pets) at least 50 ft. away from the work area.



Beware of sharp blades. Blades continue to rotate after the motor is switched off.



Switch off and remove isolator key before adjusting, cleaning and before leaving the product unattended for any period.



Do not operate on inclines greater than 15°. Mow across the face of slopes, never up and down.



Beware of electric shock hazard.



Wait for all components of machine to have completely stopped before touching them.



The charger is intended for indoor use only.



The machine is protected against ingress of water drop from vertical direction.



CE Marking
The product meets demands and regulations set by the European Community.



CAUTION! Unusable power tools do not belong with domestic waste. They must be taken to a communal collecting point for environmentally friendly disposal in accordance with local regulations.

Disposing of the packaging:



The packaging is made of cardboard and separately labeled foil which is also recyclable. Please take these materials to a recycling centre.

Battery packs/batteries:



Do not dispose of batteries into household waste, water or fire. Battery packs/batteries must be collected, recycled or disposed of in an environmentally friendly way.

Only for EC countries:
Defective or dead batteries must be recycled according to the directive 2006/66/EC



Noise level marking
Your tool noise is not more than 96dB.



PRODUCT DESCRIPTION

The safe use of this product requires an understanding of the information on the product and in this operator's manual as well as a knowledge of the project you are using. Before use of this product, familiarize yourself with all operating features and safety rules.

DETAILED DESCRIPTION OF THE PRODUCT

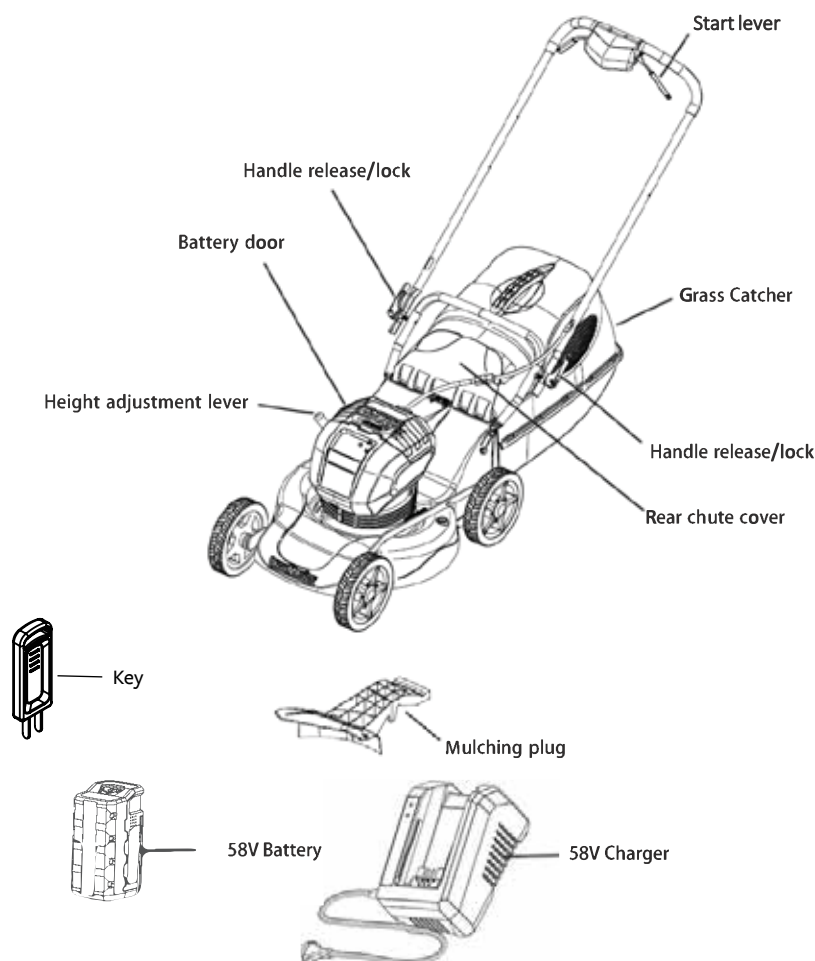

The single lever height adjustment makes for easy change from one height setting to another. There are ten cutting heights available (from 10mm-65mm) and the most suitable height should be selected that best suits the grass and weather conditions. To adjust the height of cut setting, follow the steps below.

- Grip the height adjustment lever by the black knob.
- Apply an outward force to the lever to disengage it from the quadrant rack setting.
- Holding the lever out, move the lever up or down the quadrant rack to the desired height of cut.
- Engage the lever into the quadrant rack by releasing the outward force.

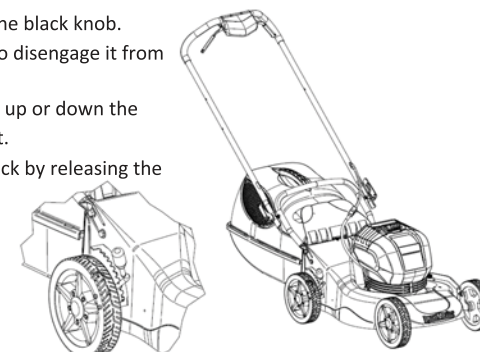

Note when using a mulching mower, using the higher height settings will give the best mulching performance. On some models there are two holes in the axle bell cranks on the left hand side of the mower. The correct setting for the connecting rod link is to have the rear of the link in the top hole and the front of the link in the lower hole.

SLOPE GAUGE



WARNING

Slopes are a major factor related to accidents involving slips and falls, which can result in severe injury. Operating the mower on a slope requires extra caution. If you feel uneasy on a slope, do not mow it. For your safety, use the slope gauge that is included as part of this manual to measure slopes before operating this unit on a sloped or hilly area.

- Mow across the face of a slope, and never up and down. Exercise extreme caution when changing direction on a slope.
- Watch for holes, ruts, rocks, hidden objects, or bumps that may cause a slip or a trip. Tall grass can hide obstacles.
- Always be sure of your footing. If you feel like you are losing your balance, release the blade/motor control handle immediately. The blade will stop rotating within 3 seconds.
- Do not mow near drop-offs, ditches, or embankments, because you could lose your footing or balance.
- Do not mow a slope that has an angle of greater than 15°, as determined using the slope gauge.
- Do not mow wet or damp grass. Unstable footing can cause slipping.



WARNING

Do not mow a slope that has an angle of greater than 15° (a rise of approximately 2 1/2 feet [.75 m] every 10 feet [3 m]). Mow across the face of a slope, and never up and down.

USING THE PRODUCT

STARTING/STOPPING THE MOWER

TO START THE MOTOR:

- Open the battery door.
- Insert the battery.
- Insert the key.
- Squeeze the left drive lever (A) toward the handle and hold there, then squeeze the right drive lever toward the handle (B) and hold there to start the lawnmower.

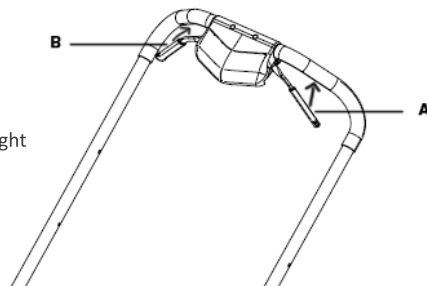

TO STOP THE MOTOR:

- Release both drive levers.

SOFT-START

This LI-ION mower is equipped with a "soft- start" feature. When initially starting up, the mower will take approx. 3 seconds to get up to full speed. If the mower does not initially start: Remove the battery and check under the mower deck to ensure there is nothing obstructing the blade and that the blade can spin freely by hand. Even a small amount of grass on start up will prevent the "softstart" from turning the mower on.



WARNING

Do not attempt to override the operation of the safety lock-out button or drive levers.



WARNING

The operation of any mower can result in foreign objects being thrown into the eyes, which can cause severe eye damage. Always wear safety glasses while operating the mower and while performing any adjustments or repairs.

WARNING

Ensure that other people and pets remain at least 30 m away when the mower is in use.

INSPECT THE CUTTING AREA

Remove all stones, sticks, wire, bones, and other debris that might be thrown by the rotating blades.

CUTTING HEIGHT ADJUSTMENT

When shipped, the wheels on the mower are set to a low-cutting position. Before using the mower for the first time, raise the cutting position to the height best suited for your lawn. The average lawn should be between 1" to 2" (2.5 to 5 cm) during cool months and between 2" and 3 1/2" (5 cm to 8.3 cm) during hot months.

TECHNICAL DATA

58V LITHIUM LAWNMOWER

58V LITHIUM LAWNMOWER	
Model	LB010004
Battery type	58 V DC Lithium-ion
Charge time	2 hours (4.0 Ah battery)
No-load speed	2800-3300 rpm
Cutting width	460 mm
Catcher capacity	45 L
Height adjustments	2.5 - 7.5 cm (6 positions)
Functions	Mulch & Catch
Weight (with 4Ah battery)	26 kg

BATTERY AND CHARGER

Battery Pack	BAT58V-4AH
Weight	1,67 Kg
Charger	CHAR-50HZ
Weight	0,87 Kg
Compatible Battery Pack	BAT58V-2A, BAT58V-4A

NOTE: LawnMaster reserves the right to modify the specifications of the device without prior notice.

ASSEMBLY

UNPACKING

Before beginning assembly of product, make sure all parts are present. Compare parts with package contents list and hardware contents list. If any part is missing or damaged, do not attempt to assemble the product.

- Carefully remove the product and any accessories from the box. Make sure that all items listed in the packing list are included.
- Inspect the product carefully to make sure no breakage or damage occurred during shipping.
- Do not discard the packing material until you have carefully inspected and satisfactorily operated the product.



WARNING

- If any parts are damaged or missing do not operate this product until the parts are replaced. Using a product with damaged or missing parts could result in serious personal injury.
- Do not attempt to modify this product or create accessories not recommended for use with this product. Any such alteration or modification is misuse and could result in a hazardous condition leading to possible serious personal injury.
- Do not insert battery until assembly is complete and you are ready to mow. Failure to comply could result in accidental starting and possible serious personal injury.
- Never operate the mower without the proper safety devices in place and working. Never operate the mower with damaged safety devices. Operation of this product with damaged or missing parts could result in serious personal injury.

Blade care

Check the condition of the blades, bolts and cutter assembly regularly. Remember that badly worn blades will affect grass cutting, catcher fill and cause excessive mower vibration.

Change worn or damaged blades



Always remove the battery when working on the blade assembly. This will prevent accidental engine start.

BAR BLADE ASSEMBLY

1. Tip the lawnmower on its side.
2. Remove the centre bolt; pull the blade and carrier off the engine shaft.
3. Either sharpen and balance the old blade or fit a new one.
4. Grease the engine shaft; assemble in reverse order.
5. Torque the centre bolt to 50 Nm.

It is recommended that you use an authorised Service Agent for any replacement, sharpening or balancing blade work.

Blade replacement torque settings

Centre Bolt 50 Nm



TO INSTALL BATTERY PACK

- Lift and hold up the battery door (1).
- Align the battery (2) with the mower's battery port.
- Make sure the battery release button (3) snaps in place and that battery is fully seated and secure in the mower before beginning operation.
- If the machine is not going to be used immediately, remove the battery.

TO REMOVE BATTERY PACK

- Release the drive levers to stop the mower.
- Press the battery release button (3) on the mower. Open the battery door.
- Remove battery from the mower.

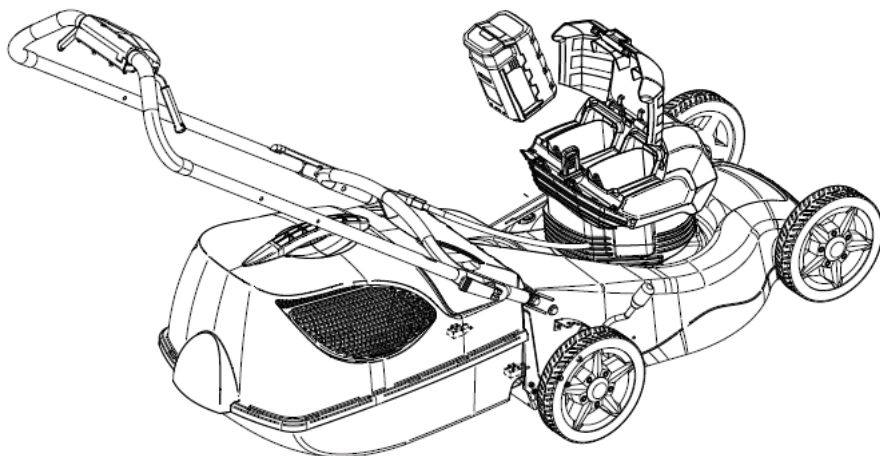

PACKAGE CONTENTS LIST

PART NAME	FIGURE	PART NO.
Lawn Mower + Key		1
Mulching Plug		1
Grass Catcher		1
58V Battery		1
58V Charger		1
Owner's Manual		1

HANDLEBAR FOLDING INSTRUCTIONS

The handlebar assembly is supplied in the storage position for packaging purposes. The folding handle system allows for compact storage when not in use.

- Unfold the handle by lifting and turning it to its 'mowing' position.
- Lock the handlebar in this position by activating the locking lever before operating the mower.

To change the handlebars back to the storage position, simply loosen the handle locking lever and rotate the upper handlebar forward over the mower body.



HANDLEBAR HEIGHT ADJUSTMENT

The height of the handlebar can be adjusted to various heights. Lift the grass flap and secure it in the open position, loosen the four bolts two on each side connecting the handle to the mower.

- The handle can now be adjusted to the correct height by moving it.
- Hold the handle in place and tighten the bolts to secure the handle in its new position.

ASSEMBLING THE GRASS CATCHER

- 1 Place the base of the catcher onto a flat surface, a bench is ideal.

- 2 Tilting the top of the catcher forward - ease onto the base. Locate the front lugs and tilt carefully rearwards to align the remaining lugs.

- 3 Ensure both halves are aligned and the lugs engaged. Clamp together the top and bottom halves (with firm downward hand pressure) to lock securely.

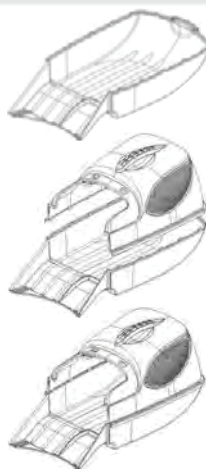

INSTALLING THE GRASS CATCHER

- Lift the rear flap (1).
- Lift the grass catcher by its handle (2) and place under the rear flap so that the hooks (3) on the grass catcher are seated on the door rod (4).
- Release the rear flap. When installed correctly, the hooks on the grass catcher will extend through the openings on the rear flap.

NOTE: When using the grass catcher, do not install the mulching plug.

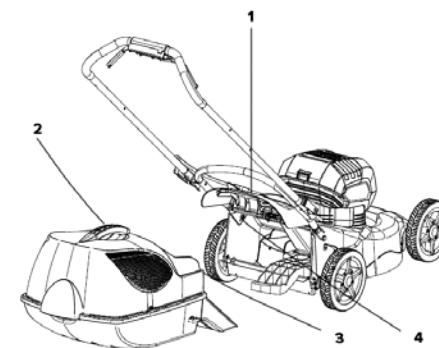

FITTING & REMOVING THE MULCHER PLUG

FITTING THE PLUG

- Stop the engine.
- Make sure the discharge chute and underside of the mower body is clean.
- Lift the rear flap of the lawnmower and remove the catcher, if fitted.
- Grasp the mulcher plug by its handle and insert into the rear of the lawnmower ensuring it is positioned correctly.
- Guide the mulcher plug in over the rear axle and crossbar and then clip into position.
- Lower the rear flap and clip over the protruding section of the mulcher plug.
- The lawnmower is now ready to use as a mulcher model.

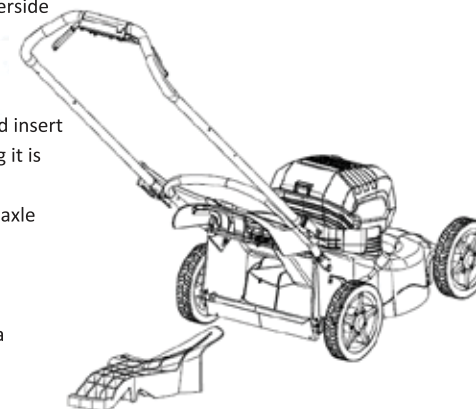

REMOVING THE PLUG

- Stop the engine.
- Press down on the handle of the mulcher plug and lift the rear flap of the lawnmower.
- Grasp the mulcher plug by its handle and lift clear of the rear axle of the lawnmower.
- Guide the mulcher plug out over the rear axle of the lawnmower.
- Lower the rear flap or fit the catcher as required.
- Clean the underside of the mower body and mulcher plug as necessary.